

CONTRACTION JOINT (CJ)
NTS

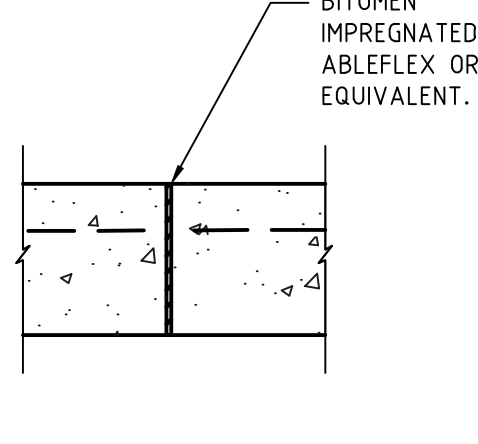

EXPANSION JOINT (EJ)
NTS

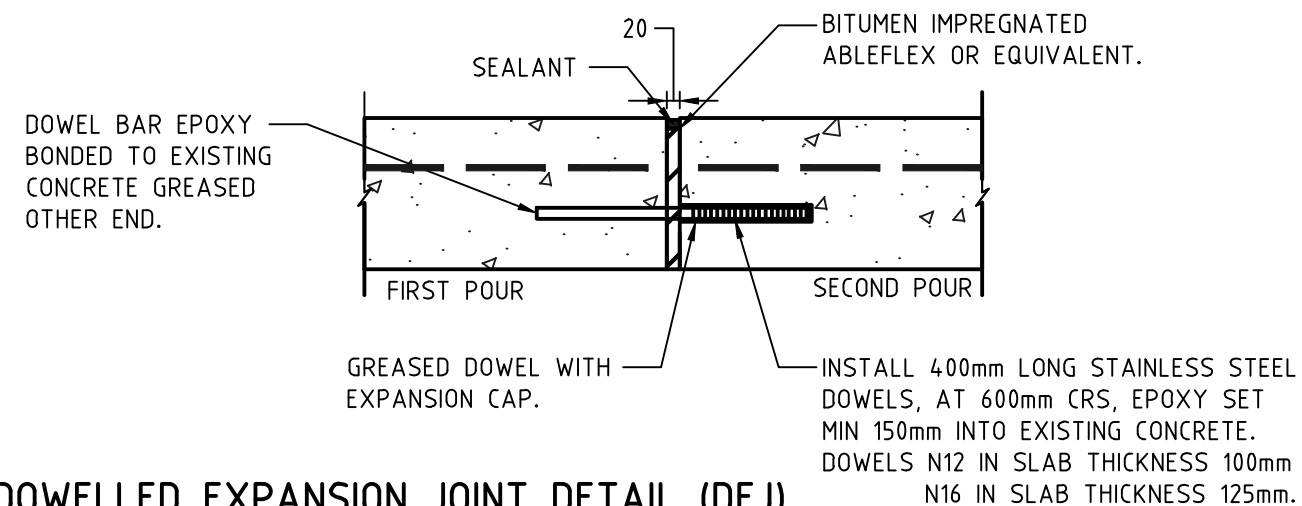

DOWELLED EXPANSION JOINT DETAIL (DEJ)
NTS

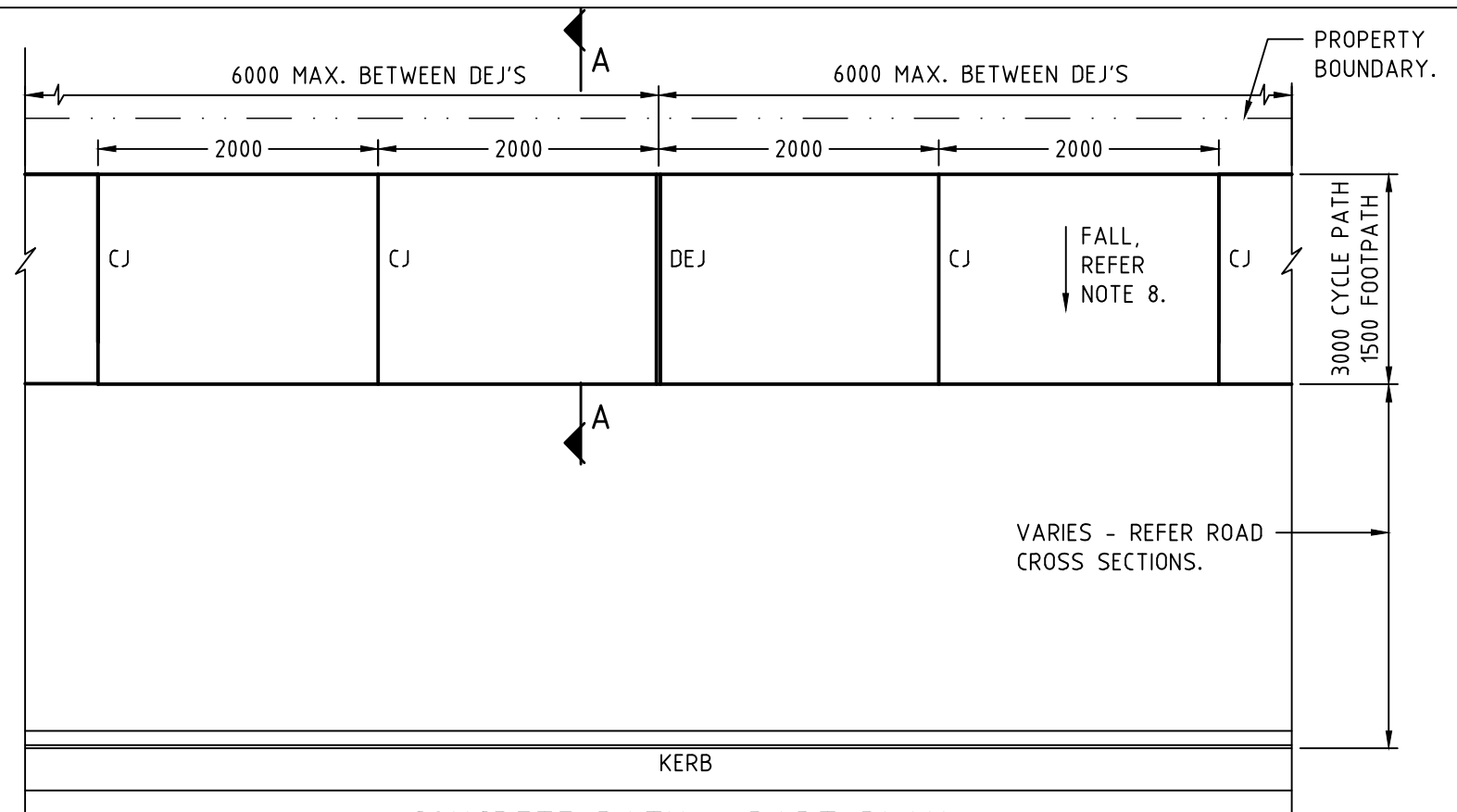

CONCRETE PATH - PART PLAN
NTS

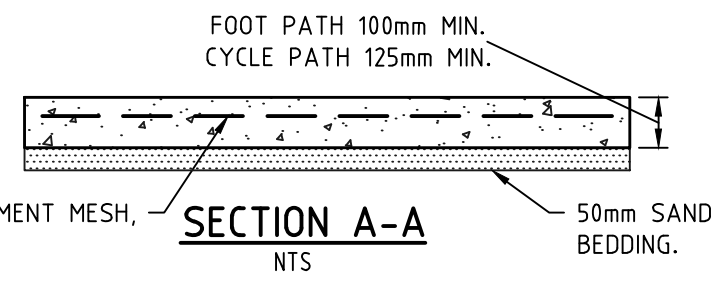

SECTION A-A
NTS

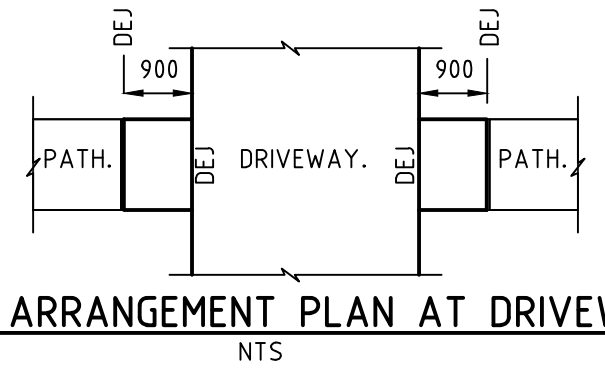

JOINTS ARRANGEMENT PLAN AT DRIVEWAYS
NTS

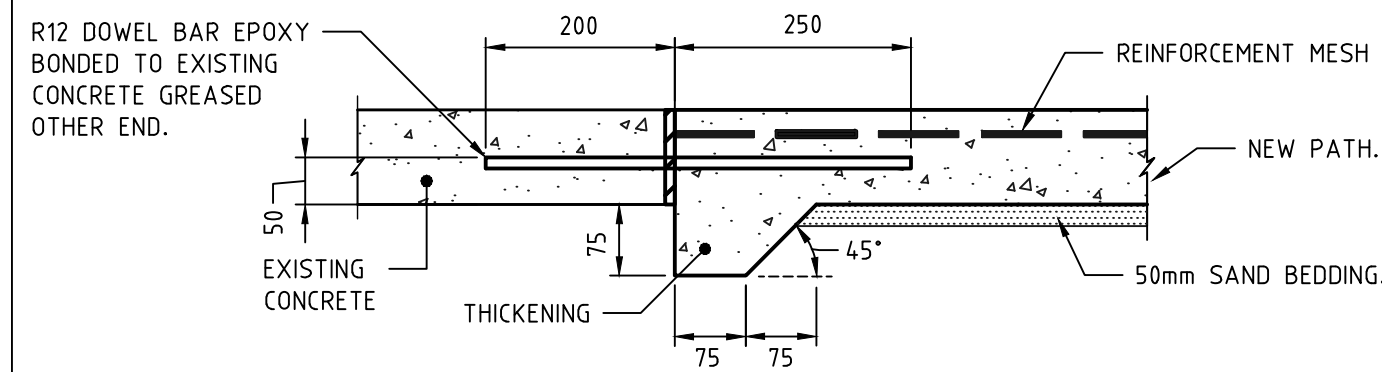

DOWEL BARS TO BE PLACED ALONG THE PATHWAY MIDWAY BETWEEN JOINTS AT 2000 CRS, OR AS APPROVED BY COUNCIL.
PATHWAY WIDENING / JOINING (MINIMUM WIDENING 800mm)
NTS

NOTES:

- 100mm THICK N25 CAST IN SITU CONCRETE FOOT PATHS WHICH MAY VARY IN WIDTH BUT SHALL GENERALLY BE MIN OF 1500mm IN WIDTH. COMPLETE WITH 1 LAYER SL62 REINFORCING.
- WHERE THE FOOT PATH CROSSES PROPERTY OWNERS DRIVEWAY. 125mm THICK N25 CAST IN SITU CONCRETE FOOTPATHS, WITH 1 LAYER SL72 REINFORCING, INDUSTRIAL DRIVEWAYS SHALL HAVE SL82 REINFORCING.
- SUBGRADE COMPACTION 95% MMDD FOR DEPTH OF 150mm.
- FORMWORK IS TO BE USED FOR VERTICAL SURFACES - NO CONCRETE IS TO BE PLACED AGAINST VERTICAL TRIMMED EARTH OR GRAVEL.
- THE TOLERANCE IN STRAIGHT EDGE DEVIATION IS 3mm IN 3m - ALL OTHER TOLERANCES ARE TO BE IN ACCORDANCE WITH THE DOI STANDARD SPECIFICATION 11 - MISCELLANEOUS CONCRETE WORKS.
- THE CONCRETE SURFACE IS TO BE STEEL TROWELED FOLLOWED BY A MOIST HAIR BROOM. THE FINAL SURFACE SHALL BE NON-SLIP AND PROVIDE A SAFE ROUTE FOR PEDESTRIANS.
- CYCLE PATHS ARE TO BE A MIN 125mm THICK N25 CAST IN SITU CONCRETE, WITH 1 LAYER SL72 REINFORCING.
- CROSS FALL 1% - 2.5% GRADIENT OR 1:100 TO 1:40 AND COMPLY WITH AS1428.
- ALL CONCRETE FOOT PATHS / CYCLE PATHS TO HAVE GLASS CULLET INCLUDED IN THE MIX UNLESS OTHERWISE APPROVED BY COUNCIL.
- DIMENSIONS ARE IN MILLIMETRES (mm) UNLESS SHOWN OTHERWISE.



ALICE SPRINGS TOWN COUNCIL
CNR TODD STREET AND GREGORY TERRACE
PHONE: (08) 89 500 500
FAX: (08) 89 530 558

SUBDIVISION AND DEVELOPMENT GUIDELINES			
FOOT PATHS AND CYCLE PATHS			
REV	DESCRIPTION	DATE	INITIALS
C	DESIGN ISSUE	05.02.18	ASTC

DRAWING NUMBER:	ASTC - 104
DESIGNED:	MP
SURVEYED:	N/A
DRAWN:	MR/TJK

AMENDMENT:	C
SCALE:	AS SHOWN
DATE:	FEB 2018